

1
Disconnect the power by turning off the circuit breaker, or by removing the fuse in the fuse box before assembling and mounting the canopy. Fix the mounting plate to the ceiling with the dowels and screws.

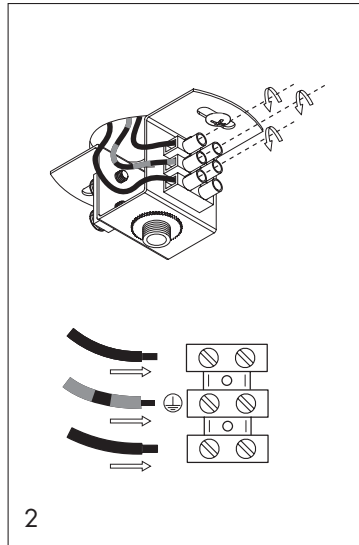

2
Connect the cable to the terminal block.

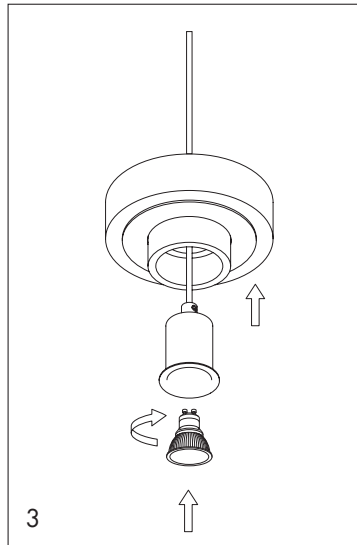

3
Attach the Gu10 LED bulb into the socket and then insert the cable into the stone.

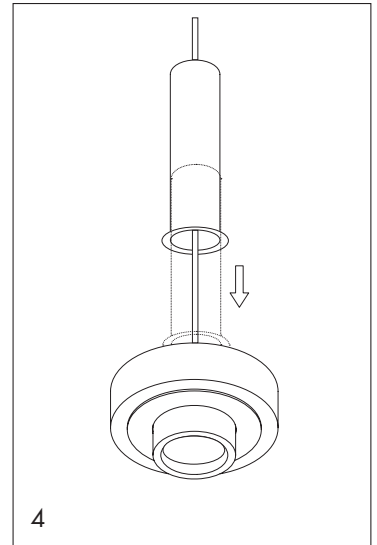

4
Insert the cable into the copper tube all the way until the base part of the tube makes contact with the top part of the stone.

*Warning: Use gloves for touch the copper tube.

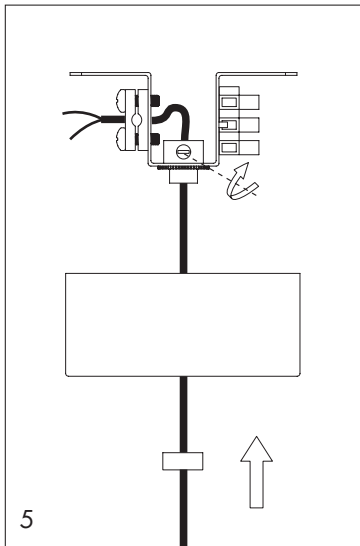

5
Fix the lamp cable with the fixing plastic screw on the ceiling box. Take care to screw gently but firmly.

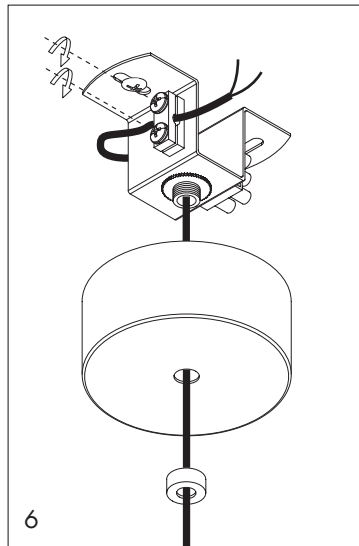

6
Fix the lamp cable with the fixing bracket on the side to double secure.

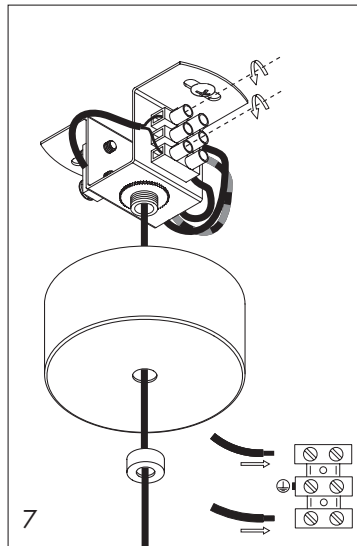

7
Connect the cable of the lamp to the terminal block.

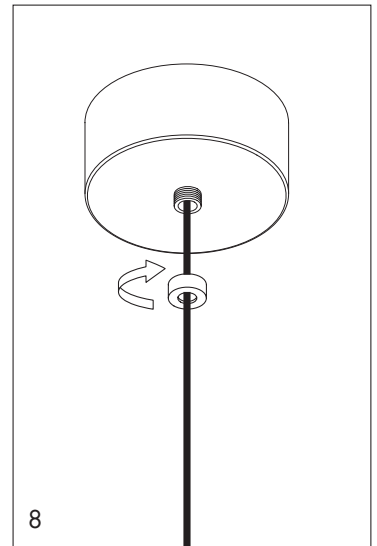

8
Fix the ceiling rose cover with the fixing nut.

safety instruction

Lamp suitable only for indoor use. The electrical connections must be carried out by specialized personnel. If this electrical wire or cord is damaged, it should be replaced exclusively by the manufacturer, its technical team or someone with an equivalent qualification in order to avoid any risk. The manufacturer is not responsible for improper use of the product.

Copper
Copper is lacquered lightly to seal and prevent patinas. Dust gently with a duster or soft cloth. Do not use commercial cleaners. A clean soft damp rag may also be used.

Cantera rosa
Use a feather duster, a clean cloth, or vacuum with a clean brush attachment, do not wipe wet.

